

FIRE REFUGE FLOOR PLAN (6TH, 10TH & 14TH) OF BLOCK A1
(SCALE 1:100)

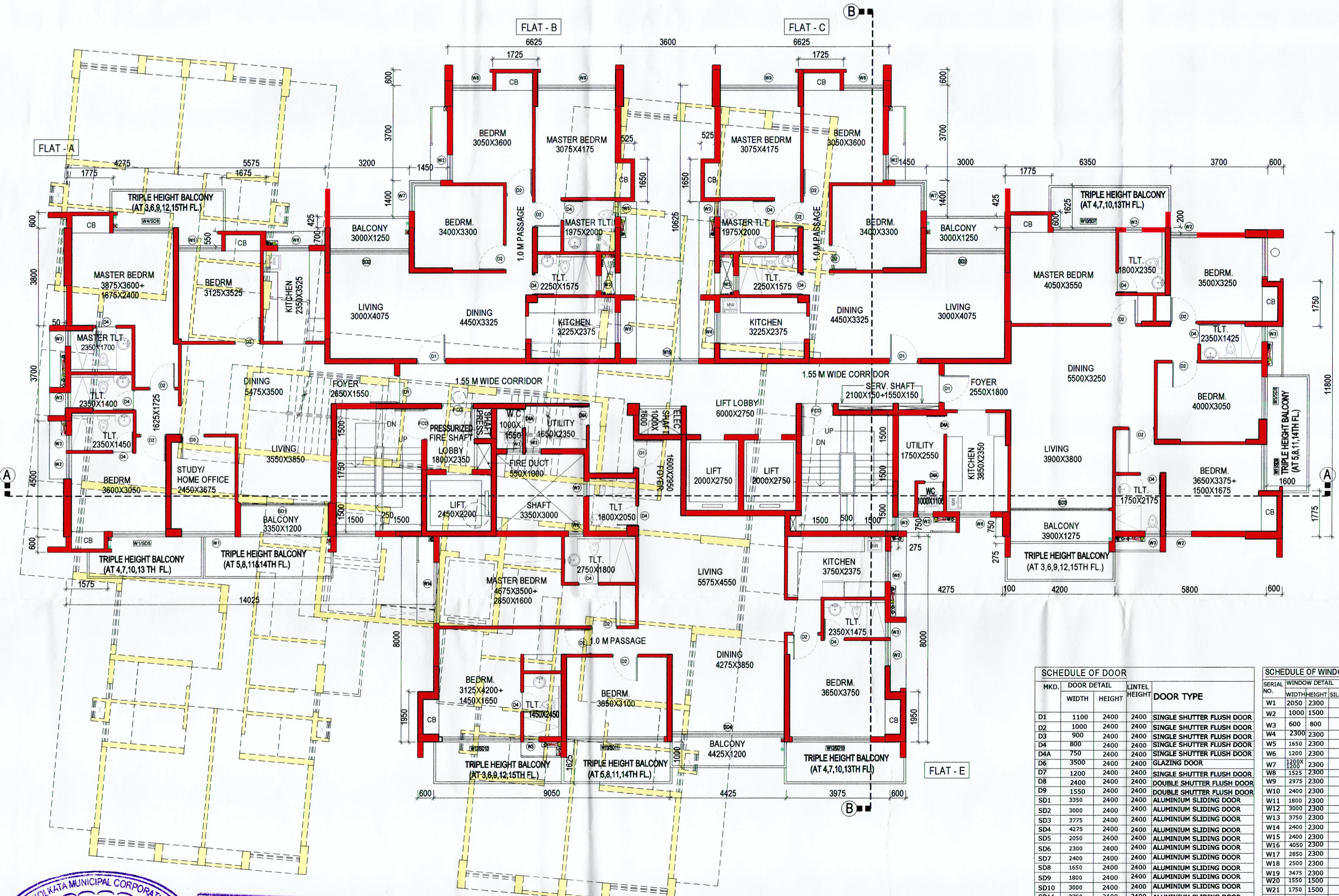

TYPICAL (2ND TO 5TH, 7TH TO 9TH, 11TH TO 13TH & 15TH) FLOOR PLAN OF BLOCK A1
(SCALE 1:100)

SCHEDULE OF DOOR				SCHEDULE OF WINDOW					
MKD.	DOOR DETAIL	LINTEL HEIGHT	DOOR TYPE	SERIAL NO.	WINDOW DETAIL	LINTEL HEIGHT	SPECIFICATION		
D1	1100	2400	2400	W1	2050	2300	100	2400	GLAZED ALUMINIUM WINDOW
D2	1000	2400	2400	W2	1000	1500	900	2400	GLAZED ALUMINIUM WINDOW
D3	900	2400	2400	W3	600	800	1600	2400	ALUMINIUM LOUVER WINDOW
D4	800	2400	2400	W4	2300	2300	100	2400	GLAZED ALUMINIUM WINDOW
D5	750	2400	2400	W5	1650	2300	100	2400	GLAZED ALUMINIUM WINDOW
D6	3500	2400	2400	W6	1200	2300	100	2400	GLAZED ALUMINIUM WINDOW
D7	1200	2400	2400	W7	1550	2300	100	2400	GLAZED ALUMINIUM WINDOW
D8	2400	2400	2400	W8	1525	2300	100	2400	GLAZED ALUMINIUM WINDOW
D9	1550	2400	2400	W9	2975	2300	100	2400	GLAZED ALUMINIUM WINDOW
D10	3350	2400	2400	W10	2400	2300	100	2400	GLAZED ALUMINIUM WINDOW
D11	3750	2400	2400	W11	1800	2300	100	2400	GLAZED ALUMINIUM WINDOW
D12	3000	2400	2400	W12	3000	2300	100	2400	GLAZED ALUMINIUM WINDOW
D13	3475	2400	2400	W13	3750	2300	100	2400	GLAZED ALUMINIUM WINDOW
D14	2950	2400	2400	W14	2400	2300	100	2400	GLAZED ALUMINIUM WINDOW
D15	2500	2400	2400	W15	2400	2300	900	2400	GLAZED ALUMINIUM WINDOW
D16	2300	2400	2400	W16	4050	2300	100	2400	GLAZED ALUMINIUM WINDOW
D17	2400	2400	2400	W17	2850	2300	100	2400	GLAZED ALUMINIUM WINDOW
D18	1850	2400	2400	W18	2500	2300	100	2400	GLAZED ALUMINIUM WINDOW
D19	1800	2400	2400	W19	3475	2300	100	2400	GLAZED ALUMINIUM WINDOW
D20	3000	2400	2400	W20	1850	1500	900	2400	GLAZED ALUMINIUM WINDOW
D21	3750	2400	2400	W21	1750	1500	900	2400	GLAZED ALUMINIUM WINDOW
D22	3750	2400	2400	W22	1725	1500	900	2400	GLAZED ALUMINIUM WINDOW
D23	3475	2400	2400	W23	1650	1500	900	2400	GLAZED ALUMINIUM WINDOW
D24	2850	2400	2400	W24	1850	1500	900	2400	GLAZED ALUMINIUM WINDOW
D25	2500	2400	2400	W25	1850	1500	900	2400	GLAZED ALUMINIUM WINDOW
D26	1475	2400	2400	W26	1475	2400	2400	ALUMINIUM LOUVER WINDOW	
D27	1200	2400	2400	W27	2500	750	-	2400	ALUMINIUM LOUVER WINDOW

THE KOLKATA MUNICIPAL CORPORATION
BUILDING PERMIT
No. 2222/1/2020
Date: 11.09.2020, Borough No. XIII
Ex. Engineer / Asst. Engineer
Bor. No. XIII, Bor. No. XIII
* BUILDING DEPARTMENT *

THE SANCTION IS VALID
UP TO 10.09.2028
Approved by M.B.C.
dt. 21.09.2020

APPROVED
ASSISTANT ENGINEER (C)
BOROUGH No. XIII

DECLARATION BY STRUCTURAL ENGINEER
THE STRUCTURAL DESIGNS AND DRAWINGS OF BOTH FOUNDATION AND SUPERSTRUCTURE OF THE BUILDING HAS BEEN MADE BY ME CONSIDERING THE SOIL TEST REPORT (AS PER THESE RULES AND THE REGULATIONS MADE UNDER THE ACT) MADE BY MR. J. PAUL FROM SKM GEOSURVEY AND ALSO CONSIDERING ALL POSSIBLE LOADS INCLUDING THE SEISMIC LOAD AS PER NATIONAL BUILDING CODE OF INDIA AND CERTIFY THAT IT IS SAFE AND STABLE IN ALL RESPECTS.

SIGNATURE OF STRUCTURAL ENGINEER
M. K. ROY
B. C. E. (Jadapur), M. Sc. TECH. (Manchester, U.K.)
A. M. C. S. T. C. ENG. M. I. STRUCT. E. (London)
Membership No. 2010800
KMC Empanelled Structural Reviewer
Class - 1, E. S. R. (I) 6/12

PROJECT
RESIDENTIAL BUILDING U/R 394 OF KMC FOR PROPOSED BLOCKS A1 & A2 B+(G+18) STORED AND EXISTING BLOCKS B1 & B2, B+(G+17) & A3 AND A4 (G+19) STORED HIGH RESIDENTIAL BUILDING AT 88 A, B.L.SAHA ROAD, BOROUGH NO.- XIII, WARD NO.- 116, KOLKATA - 700053 VIDE BS NO. 2017130170, DT 01.12.2017 AND 20/U.R-26(2a) AND (2b)/2019-2020 dt - 03/12/2019

TITLE
TYPICAL & FIRE REFUGE (6TH, 10TH & 14TH) FLOOR PLANS OF BLOCK A1

DWG. No. IN/1171/CORP2/ARA/102

SCALE 1:100

DATE 15.12.2020

JOB No. IN / 1171

ISSUE STATUS SANCTION

DRAWN BY S.S.

CHECKED BY M.K.

APPVD. BY A.B.

NOTES
- ALL DIMENSIONS ARE IN MM
- ALL EXTERNAL WALLS ARE 200 THK. AND ALL INTERNAL WALLS ARE 100MM AND 125MM THK BRICK WALL, UNLESS OTHERWISE MENTIONED.
- ALL P.C.C. WORK IN 1:3:6
- ALL R.C.C. WORK IN 1:2:4
- ALL OTHER SPECIFICATIONS CONFORMING RELEVANT I.S.I. CODE
- INTERNAL ROAD LEVELS ARE (+)150 MM FROM BOTTOM

ARCHITECT
26/2 Ballygunge Circular Road,
Kolkata 700019
www.innatendia.com
tel: (033) 4000 6424 / 25 26

INNATE
RESIDENTIAL PLANNING

This drawing is the property of M/s INNATE and might not be copied or lent without the express consent of M/s INNATE.

signature of Architect
Sanjay Mandal
COA Registration No.: CA / 98 / 23621

signature of Owner
For Sugam Griha Nirmaan Ltd.
Director
For Self and as Constituted Attorney of
1. Orbit Towers Pvt. Ltd.
2. Goodluck Infra Developers Pvt. Ltd.
3. Super Diamond Nirman Pvt. Ltd.